

# SOCKET ASSEMBLY - LANDING GEAR DOOR INSTALLATION

EXPEDITOR AIRCRAFT

## INTRODUCTION

1 The landing gear door socket assemblies Part 3MBA4288-50L and 3MBA4288-50R are situated on the undercarriage V braces. Actuating rods secured to the socket assemblies automatically close the doors when the gear is retracted.

## PURPOSE

2 Previously when the bushing in the socket assembly was worn the whole assembly would have to be changed. This socket assembly is difficult to change because it has to be bent out of shape for installation and reformed around the strut. To remedy this, the bushings Part 3MBA4288-55 are being supplied separately, thus saving material and man-hours.

## INSTRUCTION

3 Remove worn bushing and rework socket assembly hole diameter to  $.4375 \pm .001$  inches. Press fit new bushing. Ream inside bushing diameter to  $.3125 \pm .001$  inches. Bevel inside bushing edges to a depth of .03 inches at an angle of 45 degrees, see Figure 1.

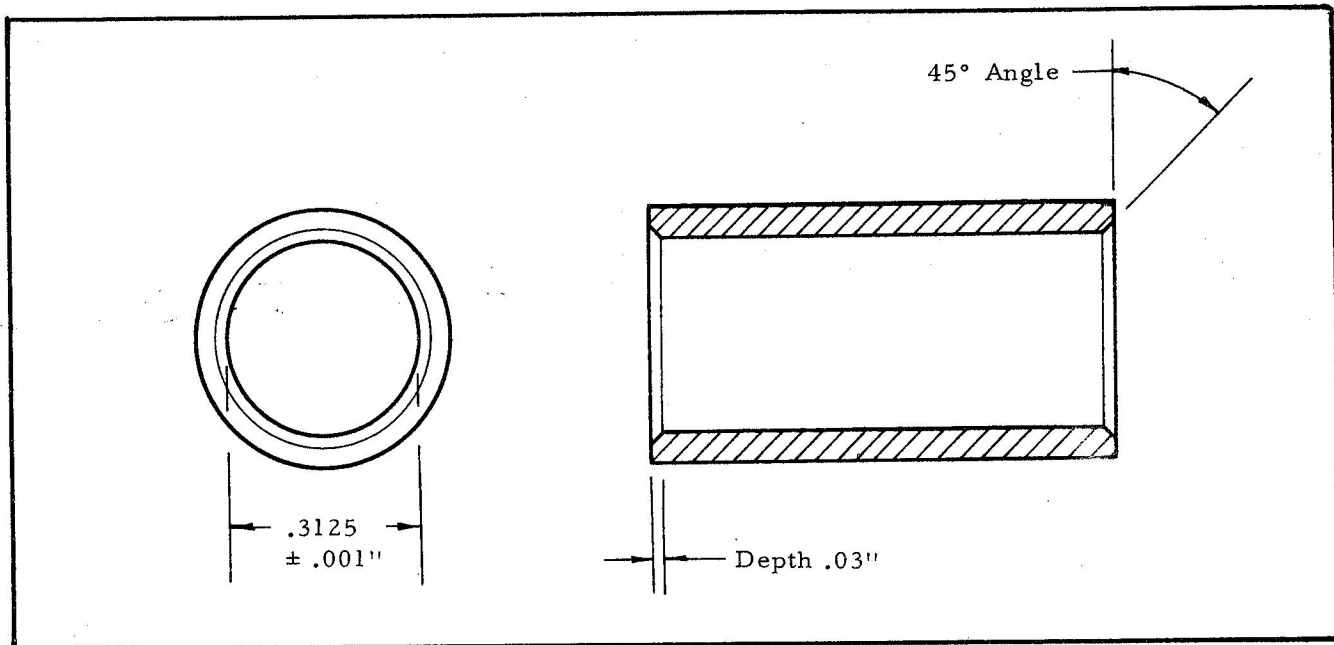

Figure 1

ISSUED ON AUTHORITY OF THE CHIEF OF THE AIR STAFF

Prepared by:  
AMC/SACO/ACR